



Better FTTx, Better Life.



April, 2026

Technical Information

# FCST-TH-SMC02 SMC Telecom Manhole Chamber

M:+86 18720624696  
Email:sales@fcst.com  
Tel:+86-21-38726791 38726792

[www.fcst.com](http://www.fcst.com)

[www.microductcoupler.com](http://www.microductcoupler.com)





## Telecom Manhole Chamber

FCST-TH-SMC02 Telecom Manhole Chamber is meticulously engineered to offer comprehensive protection, storage, equipment installation, and maintenance solutions for the underground placement of optical fiber splice boxes and cable products. This product boasts not only high stability, an extended service life, and exceptional pressure resistance, but also facilitates easy assembly.



- Excellent corrosion and weather resistance.
- Good electrical insulation and flame retardancy.
- Depth can be stacked according to requirements.
- Lightweight design using SMC composite materials.
- Complies with EN124 Standard .(B125 (12.5T)/C250 (25T))
- Prefabricated structure reduces on-site construction costs.
- Internal Dimensions: 1180\*400\*583mm(46.457"x15.749"x22.953")
- Transverse and vertical cross stiffeners are arranged around the outer side of the shaft, also be closely combined with the rammed soil layer. It is not easy to move and loosen after rolling.



EN124



### Product Specifications

Construction	Description
Executive Standard	EN124
Material	SMC
Manhole Cover Load Grade	B125(12.5T)   C250(25T)
Length	1180.00mm   46.457in
Width	400.00mm   15.749in
Depth	583.00mm   22.953in
Weight	100.8kg(1 Layer)
Flame Retardant Grade	V0
Environmental Requirements LOGO	Meet ROHS Available
Working Temperature	-40°C~+65°C
Storage Temperature	-40°C~+70°C
Service Life	30 years



**Product Size**

Product Number	External Size(L*W*D)	Internal Dimensions(L*W*D)	Manhole Cover Load Grade
FCST-TH-SMC02	1300*520*642mm (51.182"x20.473"x25.276")	1180*400*583mm (46.457"x15.749"x22.953")	B125(12.5T)/C250(25T)
FCST-TH-SMC02 (2Layers)	1300*520*1225mm (51.182"x20.473"x48.229")	1180*400*1166mm (46.457"x15.749"x45.906")	B125(12.5T)/C250(25T)

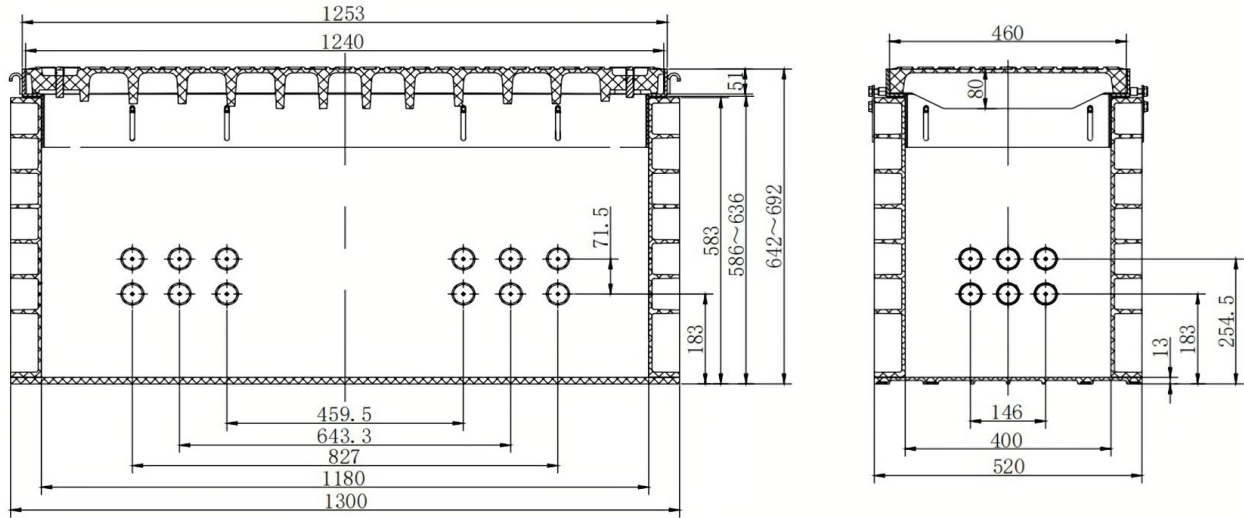

UNIT:MM

**Product Application**



Note : The practical application of this Composite Manhole Chamber, covering many fields such as municipal administration, electric power,electricity, water , road administration,and drainage.

On each side of the product. The size of the drill hole can be adjusted at the construction site according to the actual size of the HDPE Silicon Pipe/HDPE Micro-duct.



**Ordering Information**

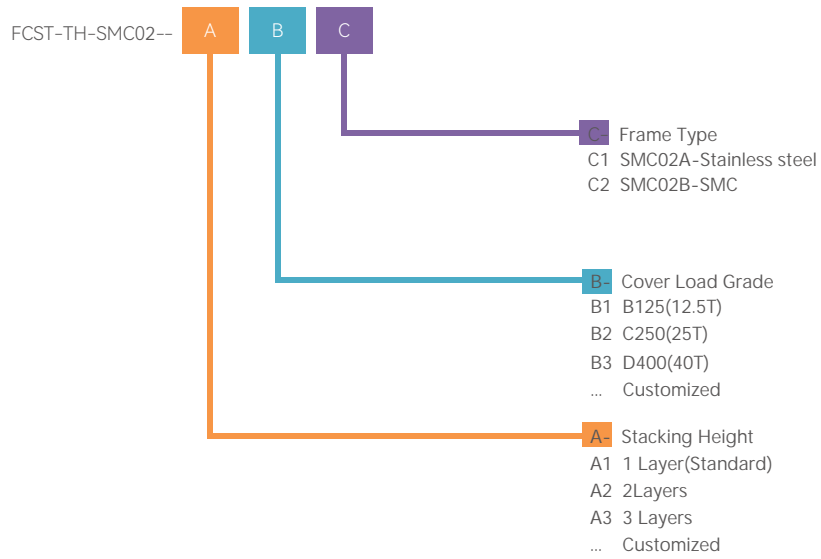

\*Note: The specified model is determined based on optional configurations. For example: FCST-TH-SMC02--A1-B1-C1.

Accessories Optional



Optional-1 FOSC Fixed Frame



Optional-2 FOSC Fixed Frame



Optional-3 FCST-Cross Cable Rack



Optional-4 Manhole Ladder

**Related Products**



Fiber Optic Splice Closure



Fiber Optic Cable



Micro Duct Connector



Micro-duct



Better FTTx, Better Life.

# Fiber Cable Solution Technology Co.,Ltd.

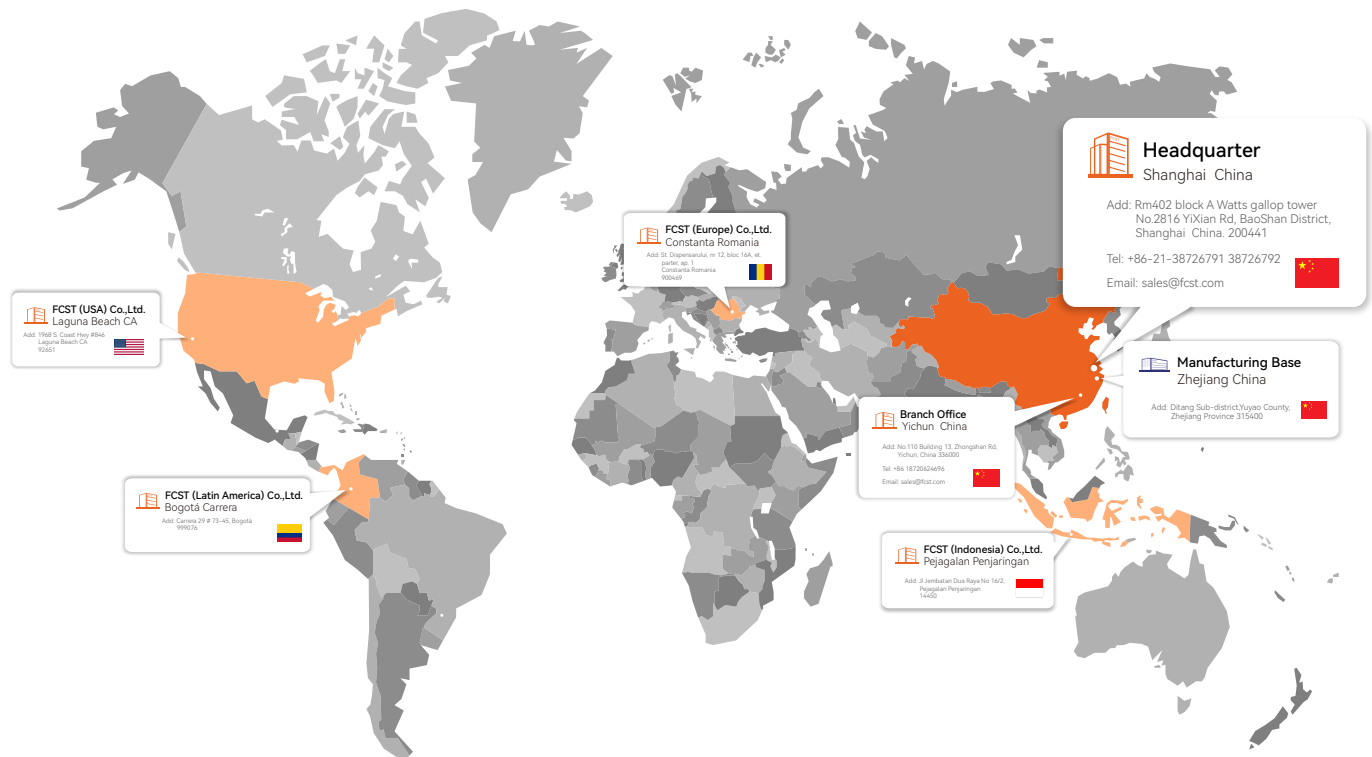

## FCST - Better FTTx, Better Life.

At FCST, we manufacture top-quality microduct connectors, microduct closure, telecom manhole chambers and fiber splice boxes since 2003. Our products boast superior resistance to failure, corrosion, and deposits, and are designed for high performance in extreme temperatures. We prioritize sustainability with mechanical couplers and long-lasting durability.

FCST aspires to a more connected world, believing everyone deserves access to high-speed broadband. We're dedicated to expanding globally, evolving our products, and tackling modern challenges with innovative solutions. As technology advances and connects billions more devices, FCST helps developing regions leapfrog outdated technologies with sustainable solutions, evolving from a small company to a global leader in future fiber cable needs.

Rm402 block A Watts gallop tower No.2816 YiXian Rd, BaoShan District, Shanghai 200441.  
Tel:+86-21-38726791 +86-21-38726792 Fax:+86-21-38726793

www.fcst.com www.micro-duct.com

